



SUZHOU, XIANGCHENG

A launch pad for your China business development

Table of content

| | |
|---|----|
| About EU Sino | 01 |
| Innovation by EU Sino | 02 |
| Geographical Context | 04 |
| Developed Infrastructures | 05 |
| District Presentation | 06 |
| Caohu State-level Xiangcheng Economic and Technology Development Zone | 07 |
| Suzhou High-Speed Rail New Town | 08 |
| Huangdai New and High-Tech Zone | 10 |
| Supporting Policies | 11 |
| Contact | 12 |

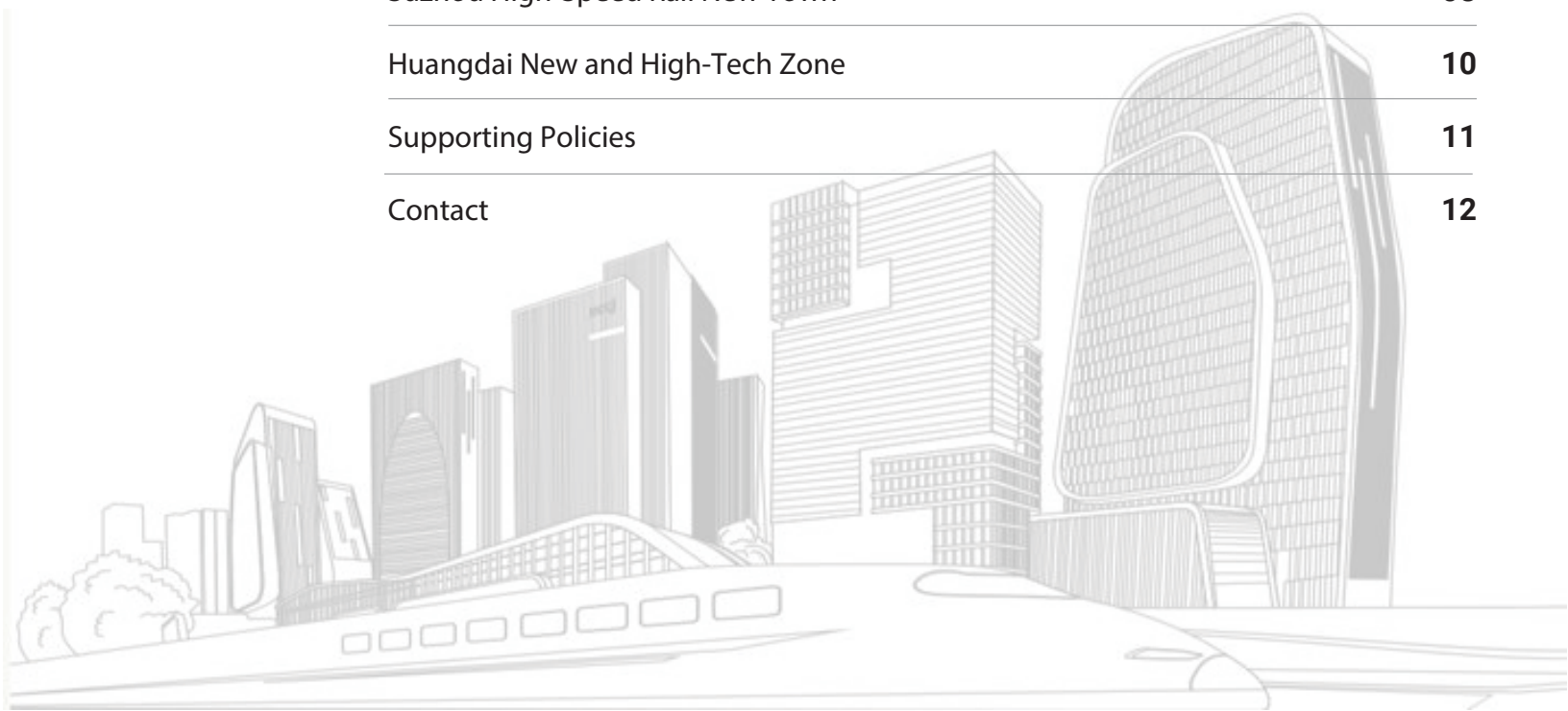

ABOUT EU Sino

We know-how !

Unlike other business consulting companies, EU Sino acts as an experienced and trusted link among three parties – foreign companies, local industries and Chinese government.

Headquartered in Suzhou - Xiangcheng District (Jiangsu Province), we assist foreign companies interested in expanding their activities or in setting up new business units in China. Our mission is to create a Sino-European network focusing on European companies in the information technology (IT), advanced manufacturing, clean technologies, automotive, and healthcare sectors.

We offer our clients an array of services, including but not limited to: assistance in preparing new business setup or smooth transition for relocation, communication with local government officials and agencies in order to secure the best possible government incentives, and consulting services to accelerate landing and business take-off in China.

EU Sino also plays an important role in assisting the local governments' drive toward more advanced industrial level. Xiangcheng District, located 25 minutes by high-speed train to Shanghai, includes several development zones and specialized parks.

EU Sino is owned, managed, and operated by a senior team of China specialists and professionals from various sectors. Its' advisory board consists of exceptional individuals whose sheer talents, long business exposure, and success both abroad and in China further warrant our expertise.

As our business grows, EU Sino partnerships network increases as well.

Here are some examples:



INNOSTATION BY EU SINO

From mainly focusing on the manufacturing industry (in the 15+ development parks of Xiangcheng) we will as of 2019 be focusing more on technology, R&D, services and office spaces.

The most exciting **new initiative driven by EU Sino** is called **INNOSTATION**, a space that will:

- Be “incubator for accelerators”, helping existing accelerators to expand to Suzhou by hosting them
- Bring together etech development agencies from varies countries to setup a base in China
- Become a stepping stone for young companies towards the Chinese (manufacturing) industry



HOSTING YOUR ORGANIZATION

Innostation, located in High-Speed Rail New Town, a division of EU Sino (WFOE), is a Not-For-Profit project, subsidized by the government to develop business. It’s a framework where your organization can fit in.

We are currently targeting several (non Chinese) accelerators and foreign development agencies to be a pioneer of this new initiative.

If your organization can be accepted to receive a rent-free period, and knowing that EU Sino will put everything in place to make you achieve success, then there’s very little risk involved for you.

You can “test the water” by starting small, during a first(test) period we can help you with a package of services that allow you to start worry-free:

- Managed closed office or only a few desks in our co-working space,
- Hosting services: company letterbox, employment, reception services, even basic incubation services neutrally supplied by EU Sino

Also in the future your expenses will be very limited, and in return we will ask that your organization is active, animates the ecosystem, develops good late-stage startups and young companies ready to scale-up.

Once your organization has come to speed, you still will be able to benefit from professional business services that are supplied neutrally by third parties from within the community and/or shared with colleague accelerators.



INNOSTATION BY EU SINO

Fit to your(client's) needs

If you see the opportunity to expand, maybe a first step in China, or maybe feel the need to jump the hype of Shanghai, Shenzhen or Beijing to a more affordable and hospitable Suzhou, or just want to host your clients in an environment that specializes on the industries they need, ... We are here to discuss the possibilities with you!

Besides the common use spaces like the cafe, auditorium and meeting rooms; you can get a dedicated space free to arrange according your business needs. Sizes come normally in blocks of 30 to 80 SQM each. We have interior developers ready to make your space within Innostation, with your corporate identity; in the format of your own large co-working area, or several private closed offices, or whatever suites your needs.

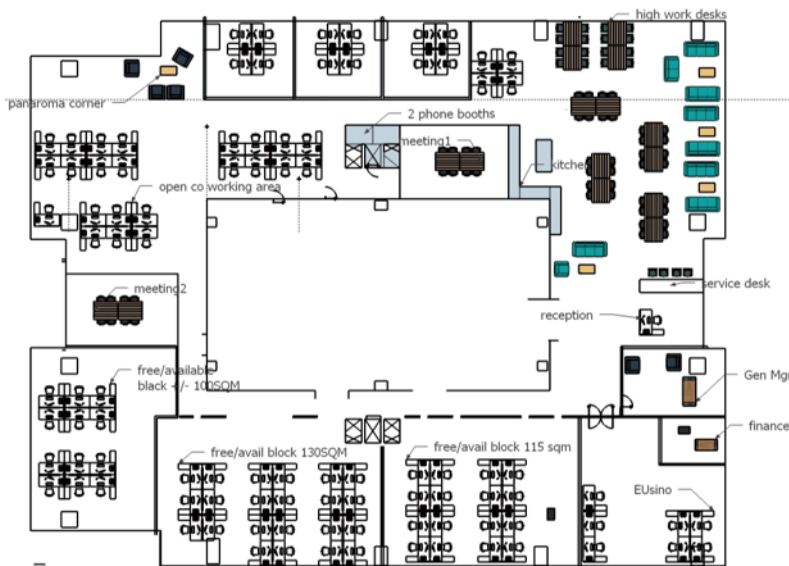

Some people see Innostation as a co-incubation space, because we deliver similar services to accelerators / incubators as co-working spaces deliver to startups.

The facilities that your organization can benefit from are for ex.: fast internet, servers, common kitchen and bar, shared meeting rooms and auditoria, etc...

But we can also help you with basic services, unless you prefer to do it by yourself, like for ex.: cleaning, accounting, company hosting, HR management, networking ,

Be part of Suzhou Innostation !

Grab the opportunity to be part of this new ecosystem and grow in China! Let's study the feasibility together and soon you may have office in the magnificent building and project.

GEOGRAPHICAL CONTEXT

Nanjing

Changzhou

Wuxi

Zhangjiagang

Changshu

Taicang

Xiangcheng District

Kunshan

SND

Gusu District

SIP

Wuzhong District

Wujiang District

Shanghai

Hangzhou

**20% of
China's GDP**

With its 490 km², Xiangcheng is a key junction along the Yangtze River Delta economic circle. It is located in Suzhou city, at the very heart of Jiangsu province, and is about one-hour ride from Shanghai, Nantong and many other industrial and commercial development areas. 20% of China's economy is reachable within two hours.

DEVELOPED INFRASTRUCTURES

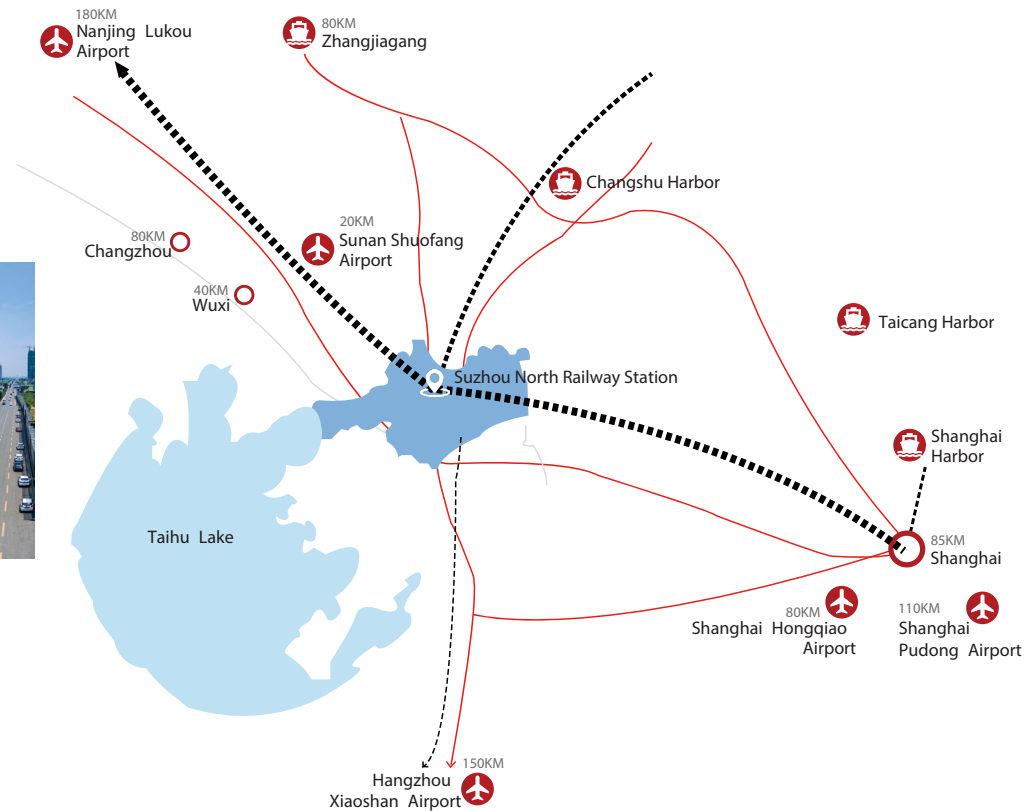

All means of transportation can be easily accessed in the surroundings of Xiangcheng. You can find five international airports, three world-class ports, twenty-two highways, two already completed metro lines to downtown Suzhou (and two more to come). With its brand-new Suzhou North railway station, Shanghai is less than 25 minutes away and Beijing less than 5 hours.

Moreover, almost all industrial areas of the district are well-equipped with high-end utilities and infrastructures such as water and power supply systems, waste treatment plants, fire stations, environment sanitation stations, etc.

Apart from this business efficient environment, Xiangcheng also wants to make the district a nice place to live and provides all kinds of living commodities such as commercial centers, schools as well as libraries, hospitals, green spaces, etc.

Suzhou is known to be the city in China with the most European style, comparable to the larger cities in the EU.

DISTRICT PRESENTATION

Xiangcheng represents a total area of 490 km² and a total population of around one million. It is divided into five zones, where each of them have a specific core industrial base:

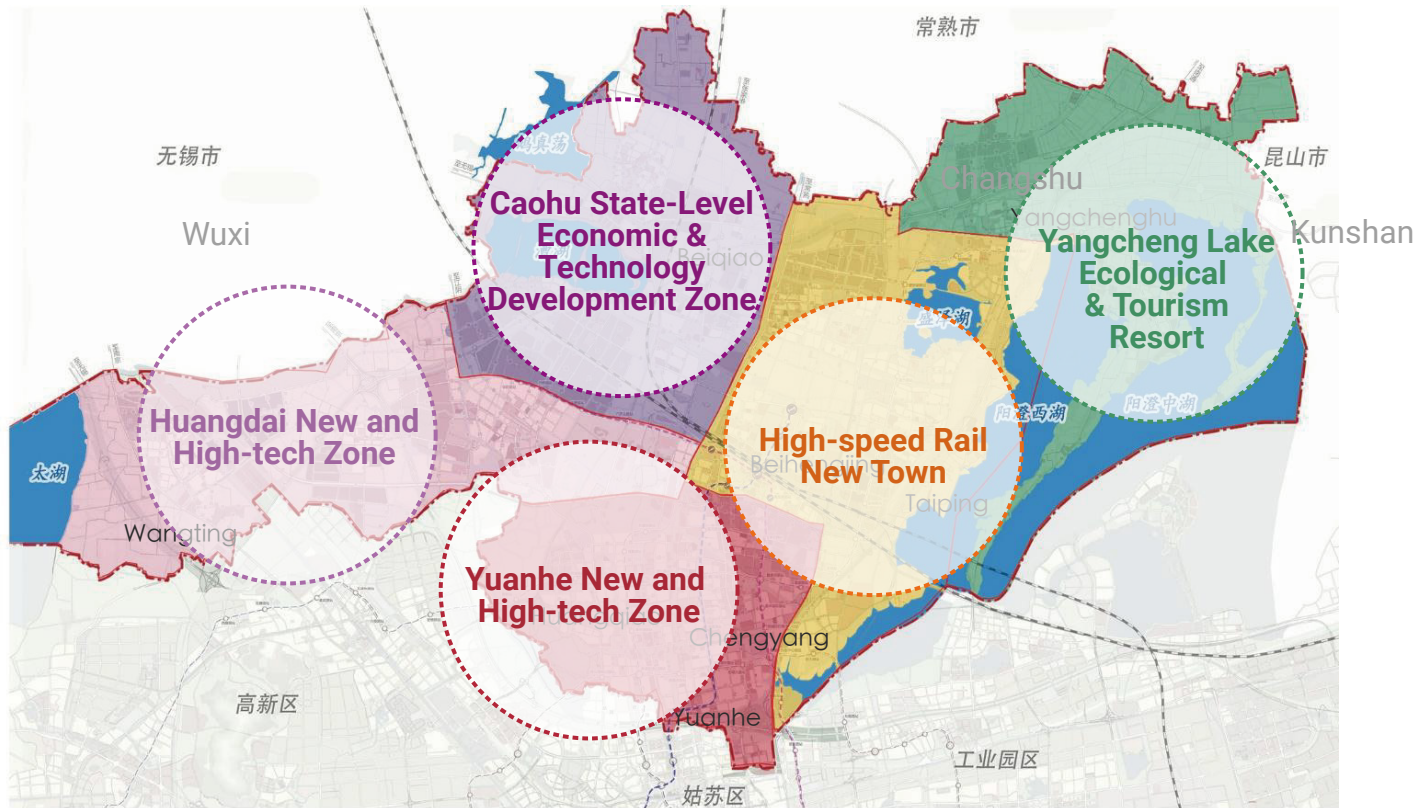

1. Suzhou High-Speed Rail New Town, with its Yangtze River Delta International R&D Community
2. Caohu State-level Economic and Technology Development Zone
3. Huangdai New and High-Tech Zone, with its intelligent manufacturing industrial base (Wangting)
4. Yangcheng Lake Ecological & Tourism Resort, with its Suzhou new materials industrial base
5. Yuanhe New and High-Tech Zone

CAOHU STATE-LEVEL ECONOMIC AND TECHNOLOGY DEVELOPMENT ZONE

This zone, covering an area of 89.5 km², can be considered as the expansion with its new functional areas: business center, new generation of electronic information industrial park, high-end equipment R&D community, AI R&D community and smart city R&D community.

This industrial cluster is based on strategic emerging industries such as next-generation electronics and IT, advanced equipment manufacturing, artificial intelligence as well as modern service industry.



Three scientific centers can also be found in this zone:

01

Suzhou Science and Technology Park of Xi'an Jiaotong University, focusing on emerging technology industries

02

Yangcheng Lake International High-tech Business Incubator, aiming at providing excellent scientific research platform and comprehensive supporting services for SMEs and micro sci-tech

03

Xiangcheng Robotics and Intelligent Equipment Research Institute of Soochow University, which develops an overall plan for R&D platform of intelligent manufacturing related to robotics.



SUZHOU HIGH-SPEED RAIL NEW TOWN

With a core area of 28.9 km², this area keeps expanding more and more. They are focusing on the orientation of “Science and Technology R&D Innovation Center”, “Pioneering Industry Cluster Center” and “International Quality Services Center”. They aim to develop the industries of Science-Technology R&D, Sci-Tech Finance and Culture & Creativity.

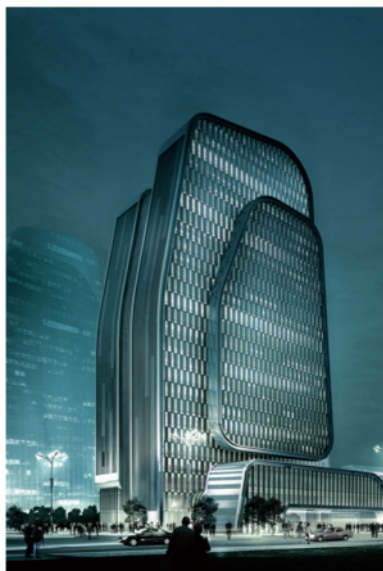

01

Xiangcheng Science and Technology Financial Industrial Park is considered as a platform to accelerate sci-tech institutions, R&D institutions and sci-tech financial organizations. They aim to build a new ecosystem based on the principles of “industry + technology + finance + talents”.

With the help of latest electronic information technology, big data and blockchain, this park focus on resource allocation, capital M&A, financial investment promoting, achievement transformation and company listing service.



SUZHOU HIGH-SPEED RAIL NEW TOWN

02

Science and Technology R&D focuses on AI & robotics, big data, cloud computing, new material technology innovation and E-commerce. This new Town will be designed as the Yangtze River Delta International R&D Community.

Yangtze River Delta International R&D Community



Example of projects:



This community of 10km² is under construction, more than 500 high-tech projects and 78 high-level talent teams and 28 innovation platforms have been introduced. This park establishes hardware facilities like R&D centers, public platforms, technology trade markets, apartments for talents, international expo center.

An intelligent public transportation system is being established here. There will be neither traffic lights nor private car on the ground.



Autonomous Driving 20 Companies Smart Driving Town

HUANGDAI NEW AND HIGH-TECH ZONE

This zone focuses on two parks: New Materials Industrial Park and Smart Manufacturing Industrial Park. Three leading industries are targeted: new generation of IT, new materials, and biomedicine. Two other emerging industries are also developing in the area: energy conservation & environmental protection, and smart equipment.



Three Scientific centers are available here:

01

Chunshen Scientific Innovation park, with a series of public service platforms for innovation and entrepreneurship

02

Xiangcheng Health Industry Incubator by the Institute of Chinese Academy of Sciences (Nanjing Branch), specialized in biomedicine and medical equipment, it has a public lab for biotech testing

03

National Engineering Research Center for Biotechnology from the Institute of Process Engineering of the Chinese Academy of Sciences (Suzhou Industrial Base), focusing on glycobiology engineering technology, biological preparations and biological materials

This zone also has a smart manufacturing industrial base: Wangting. It has developed as a high-standard and modern industrial park for high-end manufacturing such as precision machinery and intelligence production. On the east of this Base, the Wangting International Logistics Park will also serve as a logistics hub, an inland port, and a distribution & processing center.

SUPPORTING POLICIES



The local government provide incentives to companies setting up in Xiangcheng, depending on their industry scope, specific project, annual turnover, and other criteria. These incentives include but are not limited to:

- ✓ Financial subsidies and annual rewards/bonus.
- ✓ Exemption or decrease of taxes.
- ✓ Temporary rent-free offices and land supplies.
- ✓ Human resources and talent management incentives (rent subsidies, financial rewards, etc.).
- ✓ Patents and intellectual properties rewards.
- ✓ Free or subsidized participation at domestic or foreign exhibitions.
- ✓ Free legal, management, and financial experts consulting services.



CONTACT

- ✉ bd@eusinobc.com
- ☎ **+86 0512-6615-0943**
- 🌐 www.eusinobc.com
- 🌐 www.linkedin.com/company/eusino/

