



苏州新门户·城市新家园·产业新高地·生态新空间

SUZHOU NEW PORTAL · URBAN NEW HOME
INDUSTRIAL NEW HIGHLAND · ECOLOGICAL NEW AREA

SUZHOU XIANGCHENG

INVESTMENT GUIDE

| 投 | 资 | 指 | 南 |

A UNIQUE NEW CITY SOUTH OF YANGTZE
A FRIENDLY PARADISE FOR LIFE AND INVESTMENT

二〇一八年七月

目录 | CONTENTS

| | |
|----------------|---|
| 相城概况 | 01 / XIANGCHENG PROFILE |
| 交通便捷 | 03 / TRANSPORTATION CONVENIENCE |
| 产业定位和功能片区 | 05 / INDUSTRIAL ORIENTATION & FUNCTIONAL AREAS |
| <hr/> | |
| 阳澄生态新区（高铁新城）片区 | 06 / YANGCHENG ECOLOGICAL NEWZONE (HIGH-SPEED RAIL NEW CITY) |
| 漕湖国家级经济技术开发区片区 | 11 / CAOHU STATE-LEVEL ECONOMIC & TECHNOLOGY DEVELOPMENT ZONE |
| 黄埭高新区片区 | 13 / HUANGDAI NEW AND HIGH-TECH ZONE |
| 元和高新区片区 | 15 / YUANHE NEW AND HIGH-TECH ZONE |
| 阳澄湖生态旅游度假区片区 | 17 / YANGCHENG LAKE ECOLOGICAL & TOURISM RESORT |
| <hr/> | |
| 配套齐全 | 19 / SUPPORTING FACILITIES |



相城概况

XIANGCHENG PROFILE



高铁苏州北站 Suzhou North High-speed Railway Station



相城规划展示馆 Xiangcheng Planning Exhibition Hall

苏州市相城区设立于2001年，独拥阳澄湖三分之二水域，地处长江三角洲经济圈腹地和苏州大市中心，东临上海，西濒太湖，南接古城，北依长江。区域面积 489 km²，总人口100万。1.5小时经济圈可到达上海、南京、杭州。

Established in 2001, Xiangcheng is one of the newest municipal districts of Suzhou. Covering two-thirds of Yangcheng Lake, Xiangcheng is located at the hinterland of Yangtze River economic delta and the center of Suzhou, east to Shanghai, west to Taihu Lake, south to Old Town of Suzhou, and north to Yangtze River. The district covers an area of 489 km² and has a total population of 1 million. Shanghai, Nanjing and Hangzhou are within 1.5 hours' drive.

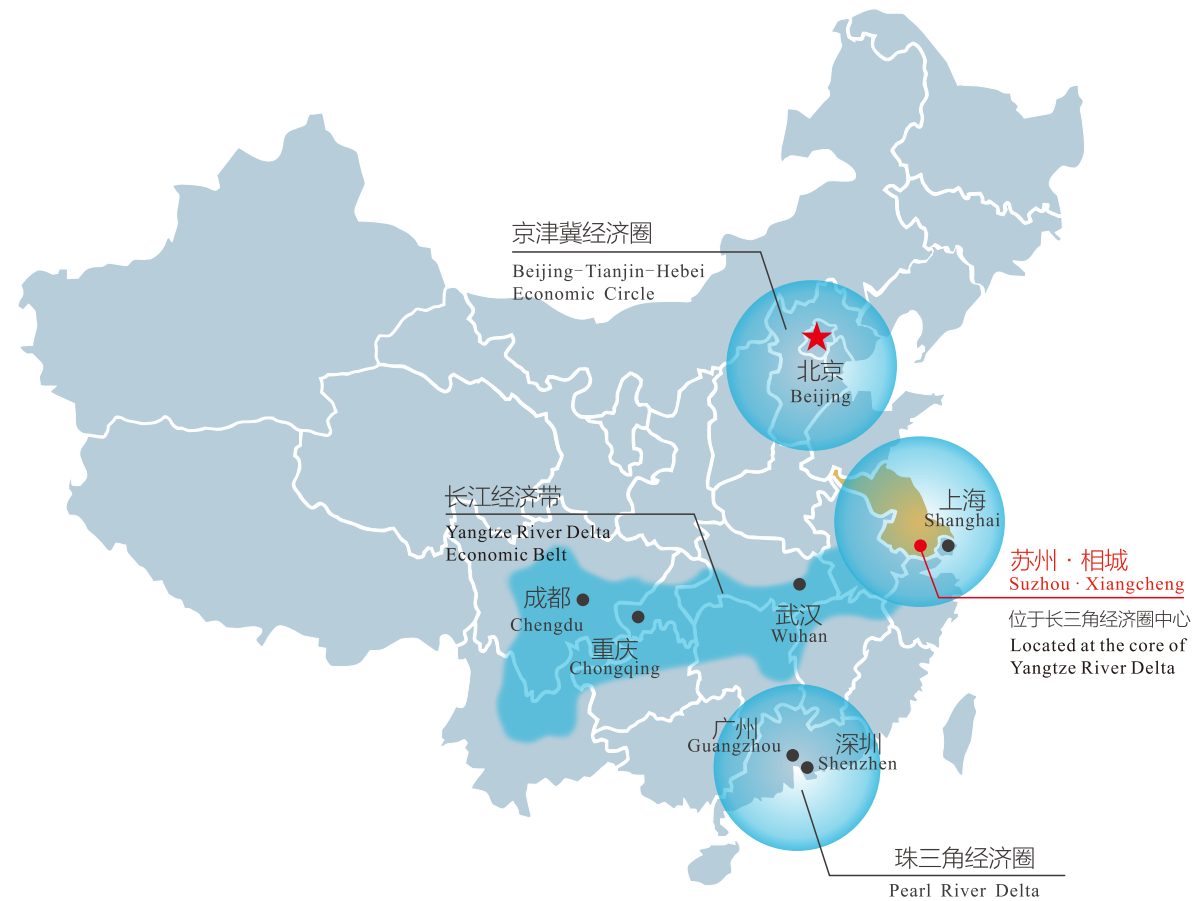

相城拥有太湖、阳澄湖、漕湖、春申湖、盛泽湖等著名湖泊，水域面积达182km²，江南水乡特色十分鲜明。全区成功创建了国家级生态区，绿化覆盖率达45.9%，主题公园11座，目前正在规划建设面积为21.7km²的城市中央公园。

Xiangcheng has famous and distinctive lakes including Taihu Lake, Yangcheng Lake, Caohu Lake, Chunshen Lake and Shengze Lake, covering an water area of 182 km². With urban green coverage rate of 45.9% in the district, Xiangcheng was successfully approved as a National Ecological Zone and has established 11 theme parks. A city central park of 21.7 km² is under planning.



阳澄湖 Yangcheng Lake



盛泽湖 Shengze Lake



春申湖 Chunshen Lake

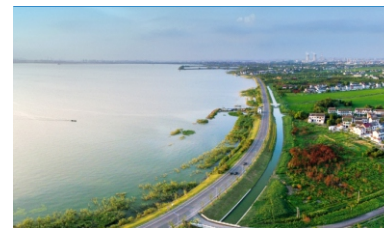

太湖 Taihu Lake

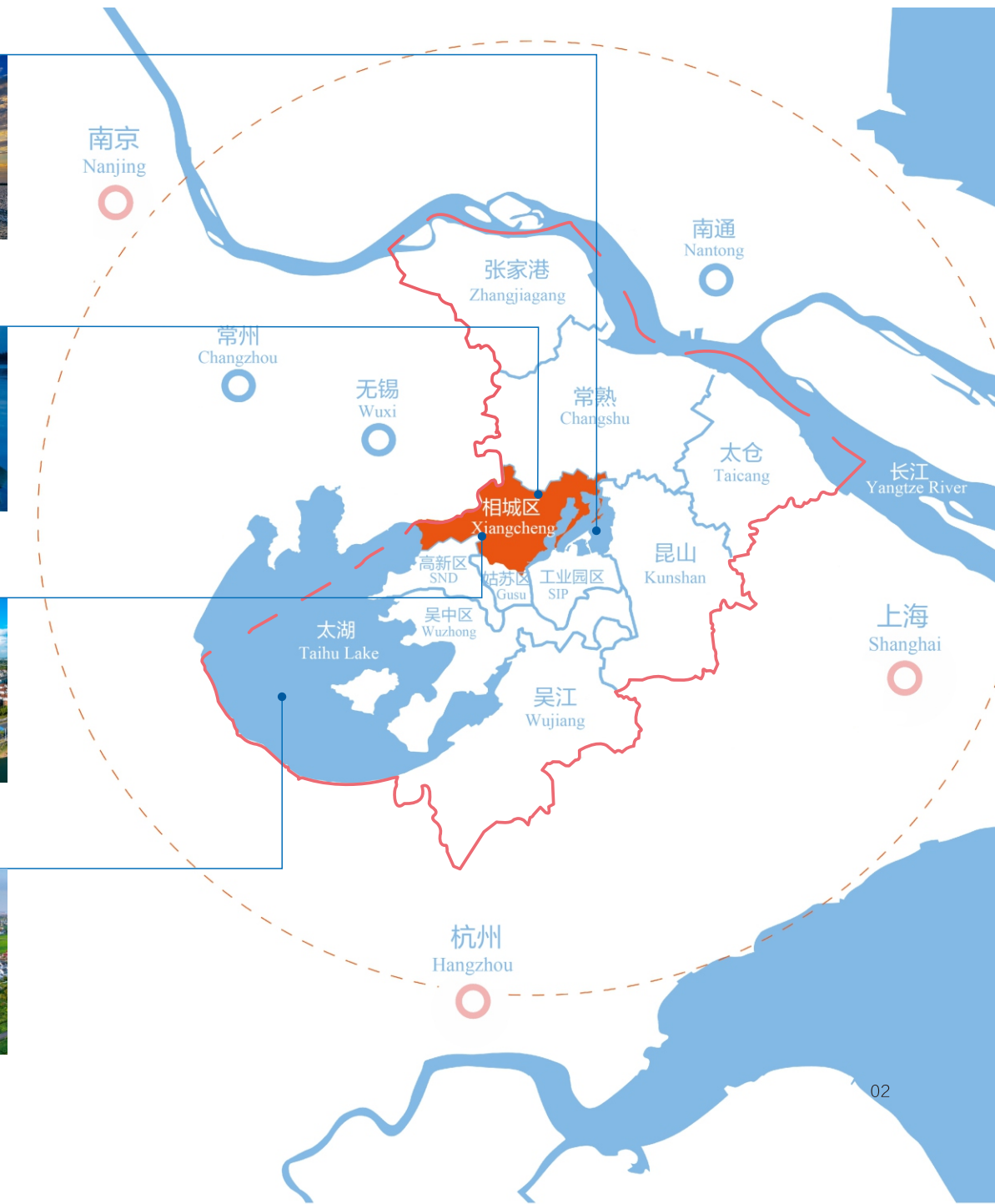

交通便捷 TRANSPORTATION CONVENIENCE

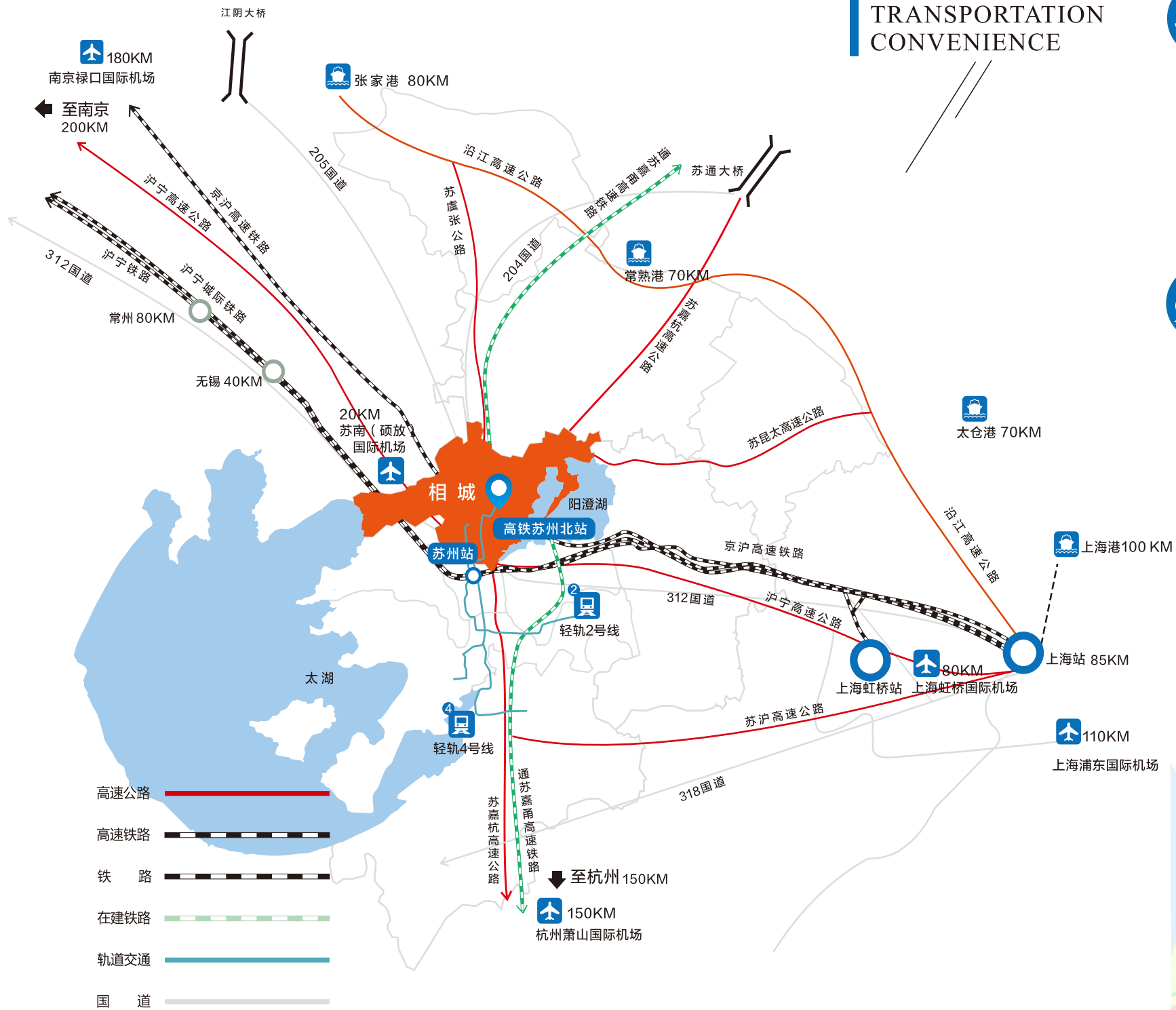

机场
Airport

1.5小时交通圈内, 拥有上海虹桥、上海浦东、杭州萧山、苏南硕放、南京禄口等5座国际机场。

Within 1.5 hours' drive, Xiangcheng has access to 5 international airports, including Shanghai Hongqiao, Shanghai Pudong, Hangzhou Xiaoshan, Sunan Shuofang and Nanjing Lukou.



铁路
Railway

京沪高速铁路苏州北站位于相城区, 至上海仅需20分钟, 到北京只需4个多小时; 通苏嘉甬高铁在苏州北站与京沪高铁交汇, 已进入招标建设。

With Suzhou North Station of Beijing-Shanghai High-speed Railway located at the heart of Xiangcheng District, it takes just over 20 minutes from Suzhou to Shanghai and 4 hours to Beijing. Meanwhile, Nantong-Suzhou-Jiaxing-Ningbo Intercity Railway, which is under construction, is going to intersect with Beijing-Shanghai High-speed Railway here in Suzhou North Station.



港口
Port

上海港、太仓港、张家港、常熟港4个优良港口以及京杭大运河提供完备的水运服务。

Shanghai Port, Taicang Port, Zhangjiagang Port and Changshu Port together with Beijing-Hangzhou Grand Canal provide comprehensive water transportation service.



高等级公路
Advanced Highway

区内有京沪、苏嘉杭、苏锡和苏州绕城4大交通枢纽、14个高速公路道口。

Beijing-Shanghai Expressway, Suzhou-Jiaxing-Hangzhou Expressway, Suzhou-Wuxi Expressway and Suzhou Ring Expressway provide 4 transport hubs and 14 expressway entrances for Xiangcheng District.



轨道交通
Metro

区内全覆盖规划建设地铁线14条, 总长度286公里, 已建成运行地铁2号、4号线。

There are 14 metro lines planned to construct with a total length of 286 kilometers in Xiangcheng District. Currently, Line 2 and Line 4 have been already in service.

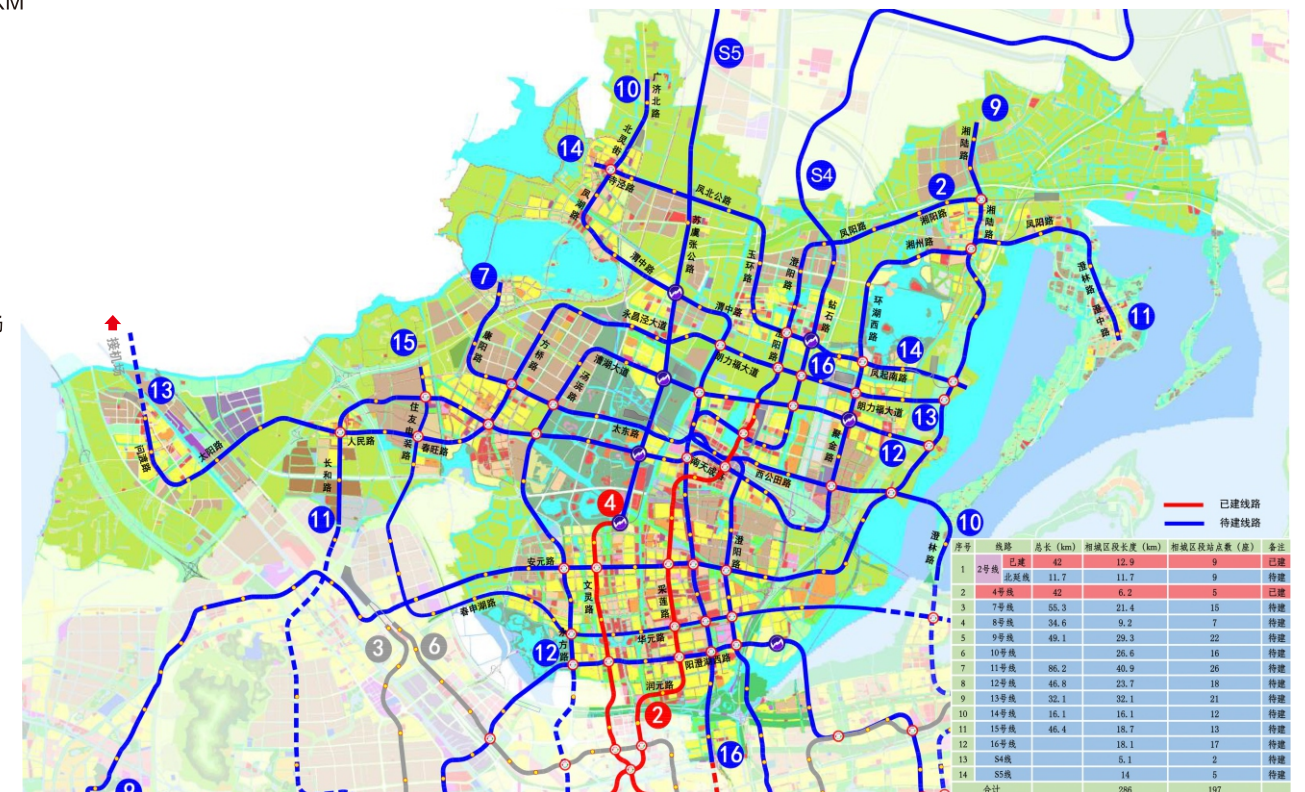

产业定位和功能片区

INDUSTRIAL ORIENTATION & FUNCTIONAL AREAS

相城区规划建设“3+2”主导产业和五大功能片区。

Xiangcheng plans to construct "3+2" leading industries and five functional areas.

| | | | | |
|--|---|-------------------------------------|--|--|
| <p>新一代电子信息 (集成电路)</p> <p>THE NEW GENERATION OF ELECTRONIC INFORMATION (INTEGRATED CIRCUIT)</p> | <p>智能制造 (机器人)</p> <p>INTELLIGENT MANUFACTURING (ROBOTICS)</p> | <p>新材料</p> <p>NEW MATERIALS</p> | <p>数字经济 (人工智能)</p> <p>DIGITAL ECONOMY (A.I.)</p> | <p>文化创意</p> <p>CULTURAL CREATIVITY</p> |
|--|---|-------------------------------------|--|--|

漕湖国家级经济技术开发区片区

CAOHU STATE-LEVEL ECONOMIC & TECHNOLOGY DEVELOPMENT ZONE

面积为 89.5 km², 重点发展新一代电子信息、智能制造等产业。

阳澄湖生态旅游度假区片区

YANGCHENG LAKE ECOLOGICAL & TOURISM RESORT

面积为 115 km², 重点发展生态旅游产业。

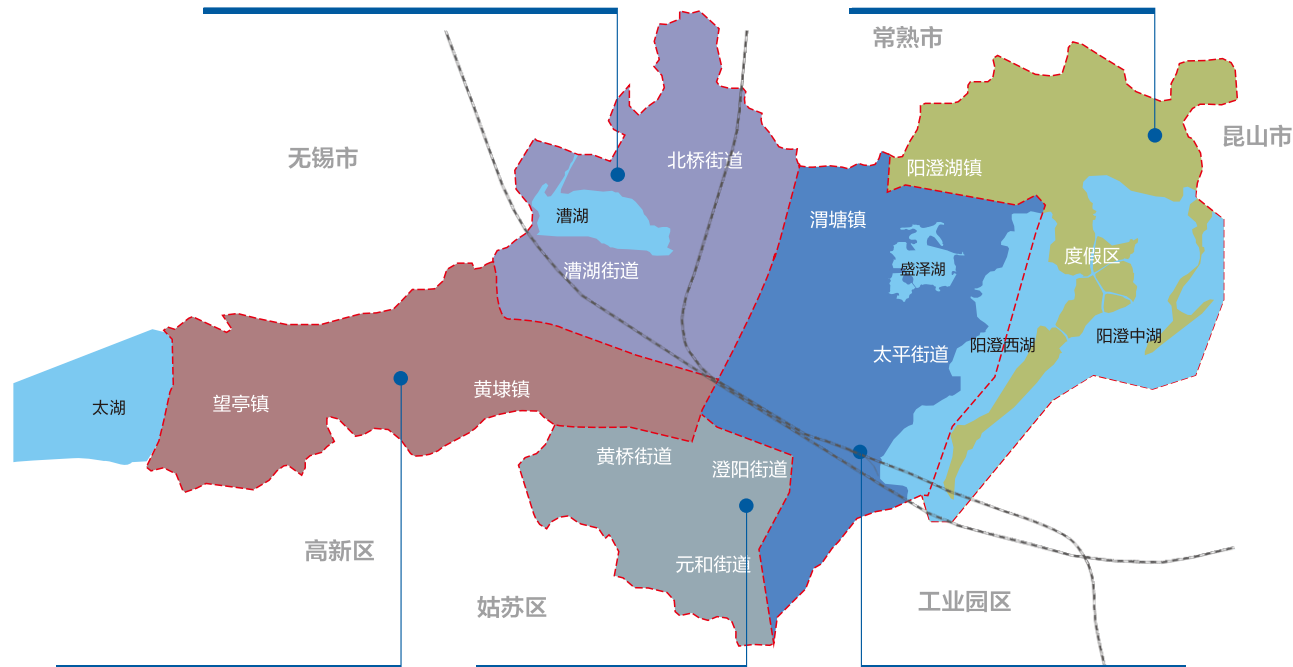

黄埭高新区片区

HUANGDAI NEW AND HIGH-TECH ZONE

面积为 112 km², 重点发展光电信息、新材料、智能装备、生物医药等产业。

元和高新区片区

YUANHE NEW AND HIGH-TECH ZONE

面积为 62.5 km², 重点发展文化创意、人工智能、大健康和商务商贸等产业。

阳澄生态新区(高铁新城)片区

YANGCHENG ECOLOGICAL NEWZONE (HIGH-SPEED RAIL NEW CITY)

面积为 110 km², 重点发展智能科技、大数据、科技金融、文化创意、电子商务等新兴产业。

YANGCHENG ECOLOGICAL NEWZONE (HIGH-SPEED RAIL NEW CITY)

阳澄生态新区(高铁新城)片区

规划构建“一主五副”的空间格局和“一环多楔、水城共融”的生态格局,重点发展大研发、大健康和大文化产业。每个功能区用环形绿廊相连、楔形绿廊相隔,区域水面覆盖率28.7%,生态绿地率20.2%。片区东侧是阳澄湖西湖,拥有47公里自然岸线,东西平均宽度3公里,规划了“六湾五嘴”世界级艺术湖区,突出打造“六大生态公园”。

By planning and constructing the spatial layout of “One core area with five communities” and ecological layout of “one ring design with multiple wedge shapes in the city merged with water”, Yangcheng Ecological Newzone aims to develop industries of international R&D, enlarged health, and holistic culture. With each community connected with a ring pergola and separated by wedge-shaped ones, the zone has a water coverage rate of 28.7% and ecological green coverage rate of 20.2%. The west part of Yangcheng Lake is on the east side of the zone. With 47 kilometers of natural shoreline and an average width of 3 kilometers from east to west, the zone is planning to create a “Six Bays and Five Sand Spits” world-class art lake area, highlighting the establishment of six ecological parks.



片区规划图
Zone Layout

ONE CORE AREA WITH FIVE COMMUNITIES

“一主五副”功能区

1 苏州市域综合功能主核

借助太平千年古镇文化底蕴,打造集聚高端公建、行政中心、国际酒店、科创平台等要素为一体的文化新门户和城市公共综合服务区,吸纳一批国际著名的行业协会和中介组织,承办一批国家级峰会论坛。

Suzhou City Integrated Function Core

Taking advantage of the cultural heritage of millennium ancient town Taiping, this core area will create a new cultural portal and an urban public comprehensive service area integrating high-end public buildings, administrative centers, international hotels, science and innovation platforms, attracting internationally renowned trade associations and intermediary organizations to host national summit forums here.



新门户·创客空间
New Portal Hackerspace



苏州阳澄湖数字文化创意产业园
Suzhou Yangcheng Lake Digital Culture & Creativity Industrial Park



世界湖区峰会湾鸟瞰图
Aerial view of Worldwide Lake Summit Bay



高铁新城规划图 Layout of High-speed Rail New City

2 阳澄国际研发社区

打造科技研发、高端配套集聚区，大力发展大数据、云计算、区块链、人工智能、科技金融等新经济产业。

YANGCHENG INTERNATIONAL R&D COMMUNITY

This community will build a cluster of science and technology R&D and high-end facilities to develop new economic industries such as big data, cloud computing, block chain, artificial intelligence, and technology finance.

3 智慧商贸创新社区

利用国内最大的渭塘淡水珍珠市场、汽车零部件产业基地，向电子商务、工业设计等高附加值产业转型。

INTELLIGENT BUSINESS INNOVATION COMMUNITY

This community will transform to high value-added industries such as e-commerce and industrial design, utilizing China's largest Weitang freshwater pearl market and auto parts industry base.

4 阳澄国际科教社区

谋划建设阳澄国家实验室等新型研发机构，打造科技教育、科技研发、科学服务的主阵地。

YANGCHENG INTERNATIONAL SCIENCE & EDUCATION COMMUNITY

The community will build new research institutions such as Yangcheng National Laboratory, building a core area for technology education, technical R&D and science service.

5 生态医疗康养社区

借助具有 II 级水标准的盛泽湖优良生态环境，打造高品质健康医疗生活服务区。

ECOLOGICAL HEALTHCARE COMMUNITY

The community will build high-quality healthcare life service area, functioning excellent ecological environment of Shengze Lake (II level water standard).

6 国际旅游度假社区

引入大型主题乐园、国际顶级假日酒店，开辟水上游线，打造阳澄湖旅游国际品牌。

INTERNATIONAL TOURISM RESORT COMMUNITY

The community will introduce large-scale theme parks and international top holiday inns, and establish aquatic tourism to build an international brand of Yangcheng Lake tourism.

CAOHU STATE-LEVEL ECONOMIC & TECHNOLOGY DEVELOPMENT ZONE

漕湖国家级经济技术开发区片区

区域面积为89.5 km²，规划建设漕湖中央商务区、新一代电子信息产业园、高端装备研发社区、人工智能研发社区、未来城市技术研发社区。以新一代电子信息、高端装备制造、人工智能科技、未来城市技术为主导产业，打造以先进制造业为主体，高端研发产业为支撑的产业集聚中心，吸引了楼氏、赛峰、泰科、天合、美的等一批世界500强企业项目，以及福耀集团、新松机器人等国内重大项目落户。



漕湖区域 Caohu Lake Area



相城经济技术开发区 西交大科技园
Science and Technology Park of
Xi'an Jiaotong University



阳澄湖国际科技创业园
Yangcheng Lake International High-tech
Business Incubator



平谦（相城）现代产业园
Pingqian (Xiangcheng) Modern Industrial Park

Covering an area of 89.5 km², the zone is planning to construct Caohu central business district, the new generation of electronic information industrial park, high-end equipment R&D community, artificial intelligence R&D community and future city technology R&D community. An industrial cluster is based on advanced manufacturing, supported by high-end R&D with industries including the new generation of electronic information, high-end equipment manufacturing, artificial intelligence technology and future city technology, attracting Fortune Top 500 companies such as Knowles, Safran, Tyco Electronics, TRW Automotive and Midea as well as domestic major projects such as Fuyao Group and Sinsun Robotics.

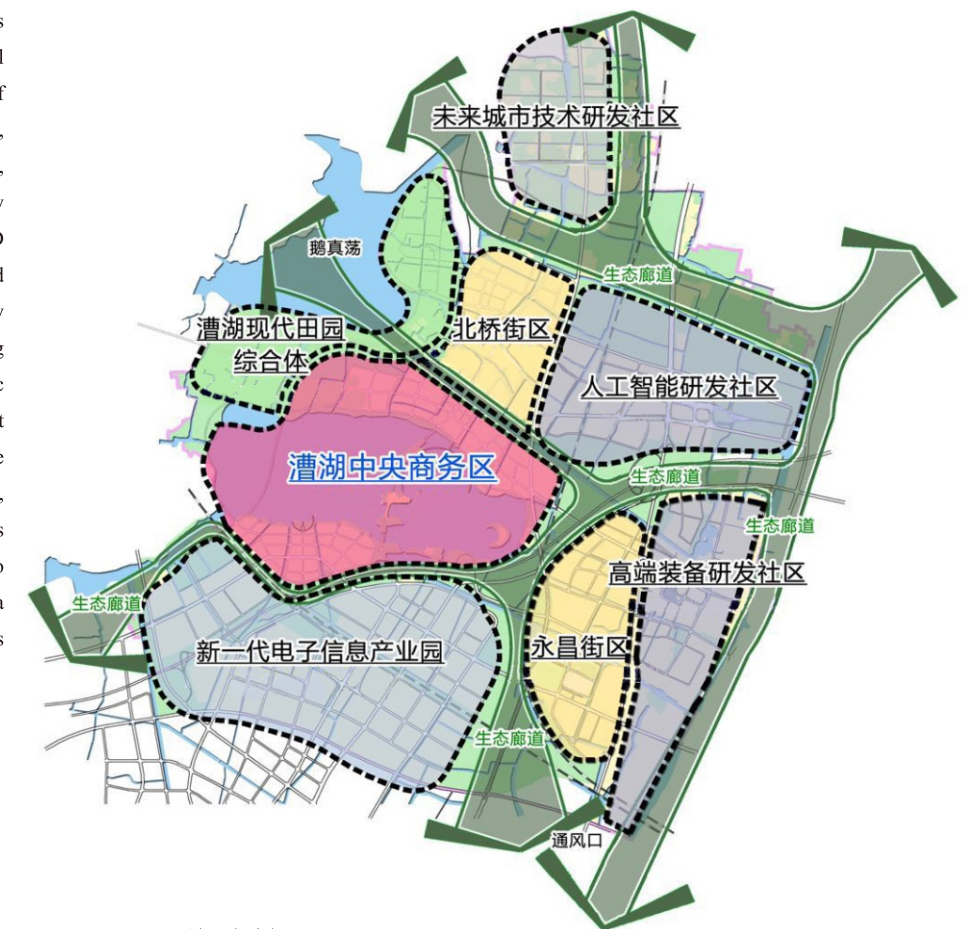

片区规划图 Zone Layout

HUANGDAI NEW AND HIGH-TECH ZONE

黄埭高新区片区

规划建设面积112 km²，黄埭高新区片区围绕光电信息、新材料、生物医药三大主导产业，培育壮大智能装备、节能环保两大战略性新兴产业。以创智核心区为主核，依托光电信息研发社区、生物医药国际研发社区、新材料研发社区，打造“一核两区三园”的产业集聚区，现已集聚欧菲光、江南高纤、住电装等内外资企业近2000家。



春申湖 Chunshen Lake



中科院过程工程研究所国家生化工程技术研究中心与南京分院相城健康产业育成中心
National Engineering Research Center for Biotechnology by Institute of Process Engineering of Chinese Academy of Sciences-Suzhou Industrial Base and Xiangcheng Health Industry Incubator

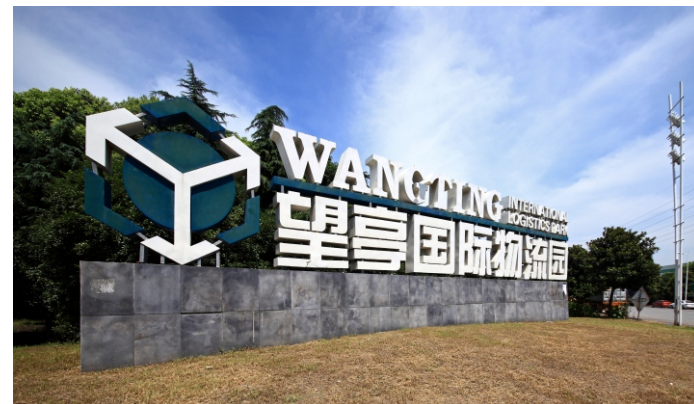

望亭国际物流园
Wangting International Logistics Park



春申国际科创园
Chunshen International Scientific Innovation Park

Covering an area of 112 km², the zone focuses on three major industries of optoelectronic information, new materials and biomedicine, cultivating two strategic emerging industries of intelligent equipment and energy conservation. Based on the central innovation and intelligence district, the zone relies on optoelectronic information R&D community, biotechnology international R&D community and new material R&D community to build a “one core, two zones and three parks” industrial cluster. It has attracted 2000 foreign and domestic enterprises such as O-Film, Jiangnan High Polymer Fiber and Sumitomo.

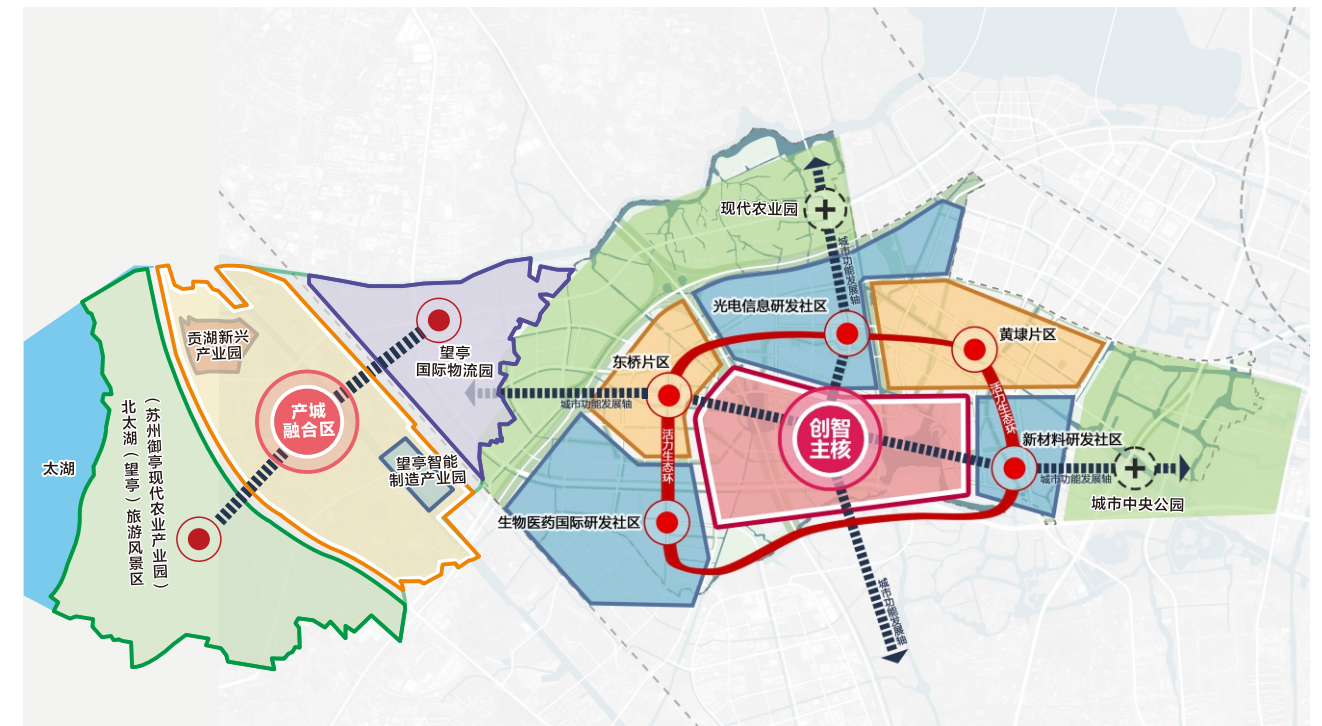

片区规划图 Zone Layout

YUANHE NEW AND HIGH-TECH ZONE

元和高新区片区

规划建设面积 62.5 km²，涵盖元和街道、黄桥街道、澄阳街道，重点发展文化创意、人工智能、大健康和商务商贸等产业。以元和塘经济文化创意带为轴，澄阳研发产业园、蠡口智能家具产业园、黄桥智能经济产业园为辐射圈，以大院大所创新产业园为集聚点，重点打造“一带三园多点”经济发展布局，加速科技创新平台载体建设，构建产城融合发展新格局。



北京大学智慧医疗大健康产业园
Peking University Smart Health-Care and Enlarged Health Industrial Park



武汉大学相城武珞科技园
Xiangcheng Wuluo Technology Park of Wuhan University



元和高新区片区
Yuan He New And High-Tech Zone



苏州国际外语学校 Suzhou International Foreign Language School

With a planning and constructing area of 62.5 km², the zone focuses on the development of industries of cultural creativity, artificial intelligence, enlarged health, and commerce and trade. Based on Yuanhe Tang Economic and Culture Innovation Belt, It is expanded by Chengyang Research and Development Industrial Park, Likou Smart Furniture Industrial Park, and Huangqiao Intelligent Economic Industrial Park. The zone highlights the “One Belt, Three Parks, and Multiple Points” economic development strategy to accelerate building the technology innovation carriers to combines the city and industries together.

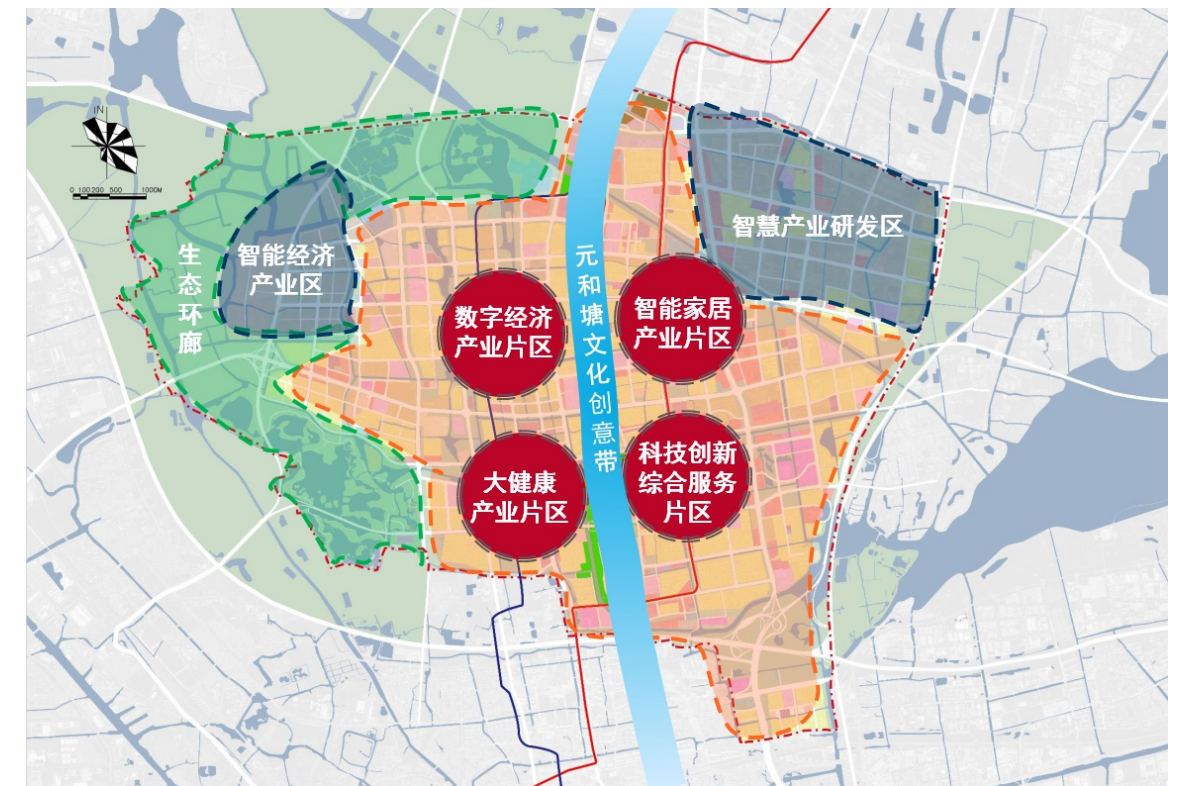

片区规划图 Zone Layout

YANGCHENG LAKE ECOLOGICAL & TOURISM RESORT

阳澄湖生态旅游度假区片区



莲花岛湿地
Lotus Island Wetland

区域面积为 115 km²，重点发展生态休闲旅游产业。度假区坐落在闻名遐迩的阳澄湖中的“美人腿”和“莲花岛”上，以盛产阳澄湖大闸蟹名扬四海。度假区将保护、挖掘、延续江南水乡独具特色的生活环境和田园风貌，以“生态”为最大特色，构建集观光、美食、娱乐、运动、商务、休闲、度假、演出等功能于一体的新一代湖泊休闲度假旅游目的地。



俯瞰美人腿
“Leg of the Beauty”



阳澄湖大闸蟹
Yangcheng Lake Hairy Crab



阳澄湖大码头 Dock of Yangcheng Lake

Covering an area of 115 km², it focuses on the development of ecological leisure tourist industry. This Resort is built on the “Leg of the Beauty” and “The Lotus Island” of the famous Yangcheng Lake, which is well known for hairy crabs. The resort will protect, discover and carry forward the unique living environment and pastoral landscape of the southern Chinese watery region. Characterized by “ecology”, it aims to become the new generation of tourism resort which embodies sightseeing, delicious food, entertainment, sports, business, recreation, vacation and shows.

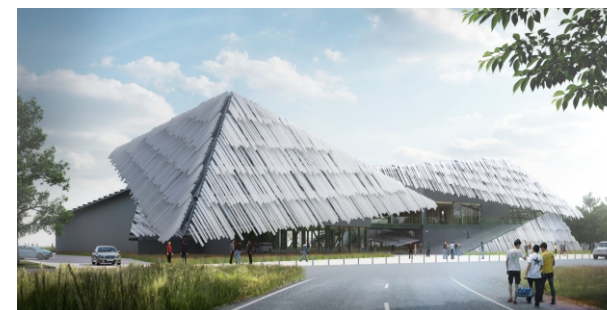

苏州阳澄湖众创空间 Suzhou Yangcheng Lake Hackerspace

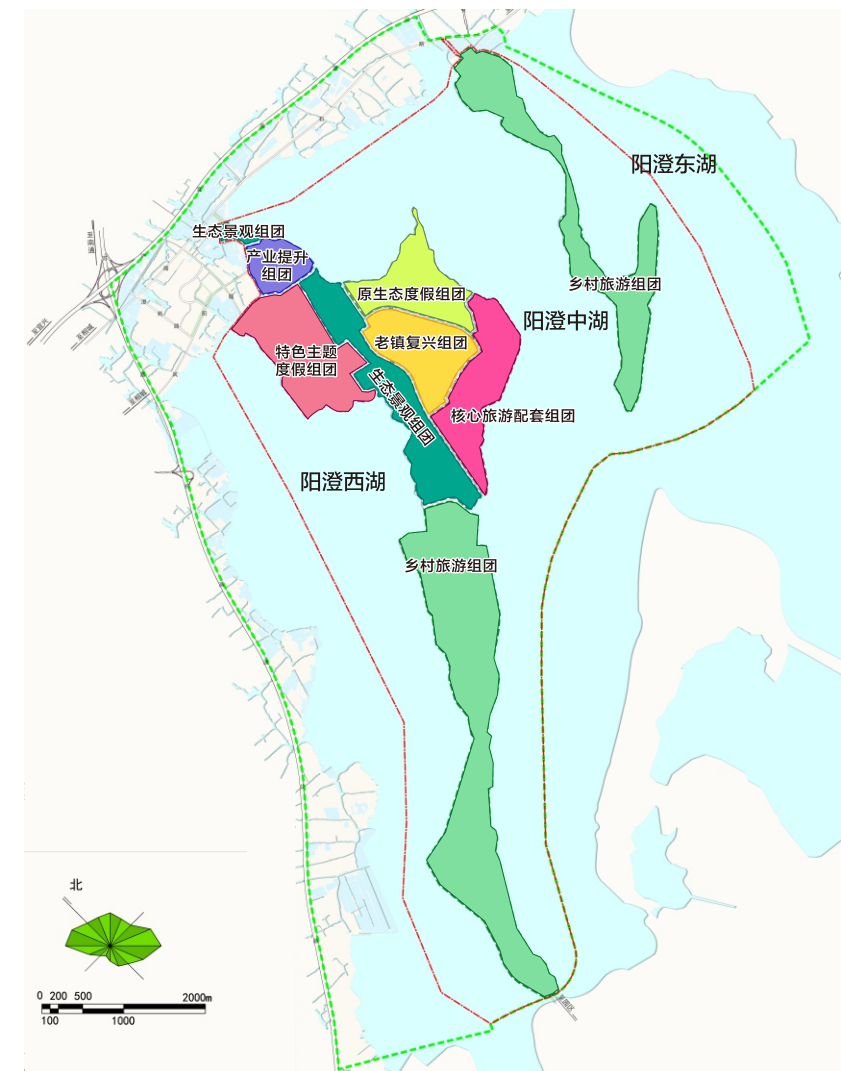

度假区规划图 Layout of Ecological & Tourism Resort

配套齐全

SUPPORTING FACILITIES:

1 完善的医疗服务

配有苏州大学附属第一医院、苏州市第五人民医院、苏州市广济医院、苏州市妇幼保健医院、区人民医院及10个乡镇卫生院和71个社区卫生服务站，已构建15分钟健康服务圈。

COMPREHENSIVE HEALTHCARE SYSTEM:

Xiangcheng has the First Affiliated Hospital of Soochow University, Suzhou No.5 People's Hospital, Suzhou Guangji Hospital, Xiangcheng People's Hospital, as well as 10 town health centers and 71 community health service stations, providing easy access to community healthcare within 15 minutes.



苏州大学附属第一医院
The First Affiliated Hospital of Soochow University



相城区人民医院
People's Hospital of Xiangcheng District

2 强大的金融支撑

已成立相城科技金融产业园，规划建筑面积约17万平方米，引进科技金融基金90余支，总规模超1000亿元。

STRONG FINANCIAL SUPPORT:

Xiangcheng Technology and Finance Industrial Park has been established with a planned area of 170,000 m². Now it has over 90 sci-tech funds with a total fund size over 100 billion yuan.

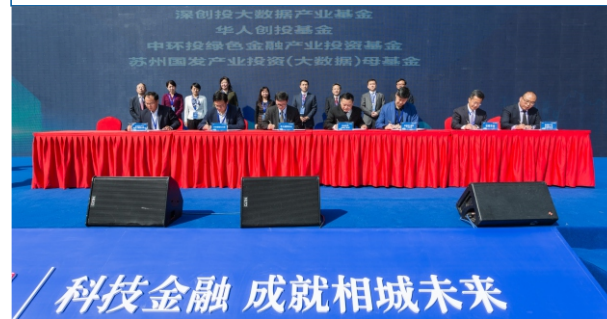

基金入驻科技金融产业园
Industrial funds' signing ceremony in Technology and Finance Industrial Park



科技金融产业园一期（兆润大厦）
Technology and Finance Industrial Park Phase One (Trirun Plaza)

3 齐全的商业配套

拥有繁花中心、圆融广场、天虹百货和在建的绿地国贸、美京假日广场、合景威斯汀酒店等商业综合体。

ALL-ROUND COMMERCIAL FACILITIES:

Xiangcheng has comprehensive commercial facilities such as FanHua Commercial Center, Harmony City and Rainbow Mall, as well as Greenland, Magic Holiday Plaza and Westin Hotel which are under construction.



圆融广场
Harmony City



天虹百货
Rainbow Mall

4 优质的教育资源

建有独立建制中小学50所，幼儿园45所。南京师范大学实验学校、苏州大学实验学校、华东师范大学漕湖学校、苏州外国语学校相城分校等优质教育资源相继落户。

HIGH-QUALITY EDUCATION RESOURCES:

Xiangcheng has 50 public primary and secondary schools and 45 kindergartens. The Experimental School Affiliated to Nanjing Normal University, Suzhou Foreign Language School Xiangcheng Campus and many other high-quality schools have been established in Xiangcheng.



苏州国际外语学校
Suzhou International Foreign Language School



苏州大学实验学校
Experimental School of Soochow University

5 充沛的人才储备

在相城半小时车程内，拥有苏州大学、苏州科技大学、独墅湖高校区等30多所高校，中职学校33所（含技工院校7所）、高职院校17所，在校生规模达40万人，为产业创新发展提供强有力人才支撑。

FULL TALENT SUPPORT:

Within 30 minutes' drive, Xiangcheng has over 30 universities like Soochow University and Suzhou University of Science and Technology. It also has 33 secondary vocational schools and 17 higher vocational schools. The number of students reaches 400,000, providing high-quality talents for industries.



苏州大学阳澄湖分校
Yangcheng Lake Campus of Soochow University



江苏省相城中等专业学校
Jiangsu Xiangcheng Secondary Vocational School

6 完备的扶持政策

SUPPORTING POLICIES

关于促进相城区智能制造产业发展的奖励办法（试行）

Incentives on Promoting the Development of Intelligent Manufacturing Industries in Xiangcheng District.

相城区独角兽企业培育工程实施计划（2018-2022）（试行）

The Cultivation Project of Unicorn Enterprises in Xiangcheng District (2018-2022) (Trial)

关于促进相城区金融业发展的实施意见

Implementation Suggestions on Promoting the Development of the Financial Industry in Xiangcheng District.

关于加快相城区文化创意产业发展的若干扶持政策（试行）

Policies on Developing Cultural Creativity Industry of Xiangcheng District (Trial)

关于调整相城区企业上市（挂牌）部分扶持政策的意见（试行）

Suggestions on Adjusting Partial Supporting Policies of Xiangcheng Enterprises Listing (Trial)

关于进一步完善阳澄湖人才计划及配套政策措施的若干意见（试行）

Suggestions on Optimization of Yangcheng Lake Talents Program and Supporting Policies and Measures (Trial)

相城区人才安居乐业实施意见（试行）

Implementation Suggestions on Xiangcheng Talents Residency Program (Trial)

相城区招商资源信息平台、办事指南及政策详情

请见区商务局网站：<http://www.szxc.gov.cn/szxc/swj>

For more information about investment and preferential policies of Xiangcheng, please visit the website of Suzhou Xiangcheng Bureau of Commerce:
<http://www.szxc.gov.cn/szxc/swj>

苏州市相城区商务局

地址：苏州市相城区嘉元路6号国检大厦3楼

招商电话

制造业：86-512-66183512

服务业：86-512-66183515

大院大所：86-512-66183517

招商传真：86-512-66836063

招商邮箱：invest@szxcbc.com

Suzhou Xiangcheng Bureau of Commerce

Address: 3F, Guojian Building, No. 6 Jiayuan Road, Xiangcheng District, Suzhou

Tel:

Manufacturing Industries: 86-512-66183512

Service Industries: 86-512-66183515

Universities and Institutions: : 86-512-66183517

Fax: 86-512-66836063

Email: invest@szxcbc.com

